





Cavity fixing, metal

PLATTI, TPP
M4 - M5
Screw and hook

x



Cavity fixing, plastic

DUO-MAX, TSP
M3 - M5
Screw and hook

x



Cavity fixing, plastic

MONO-MAX, TMM
Ø 8 mm
Screw

x



Cavity fixing, metal

TMX
M4 - M6
Screw

x



Cavity fixing, metal/plastic

TPD
4.5 x 35 mm
Screw

x



Cavity fixing, metal

THW
4.2 x 35 mm
Screw

x

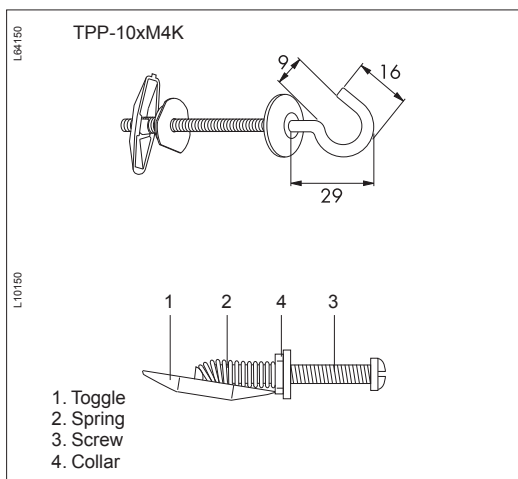
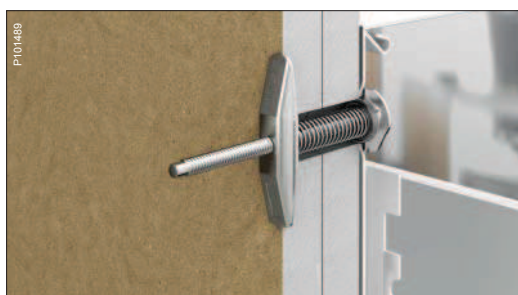

Description

PLATTI TPP is a cavity fixing consisting of a toggle and a collar, united by a spring and a screw or hook.

Application

For installations in board materials ranging from a thickness of 10 to 35 mm. Also suitable for ceiling installations.

Benefits

- Captive fixing
- No special tool needed for the installation
- Large metal toggle – withstands humidity, heat and heavy loads
- Suitable for ceiling installations
- High load values
- Fire-resistant
- Easy to remove – cut off the spring

Material data

Material	Toggle, collar	Zinc
	Screw, hook	Electroplated steel
	Spring	Steel

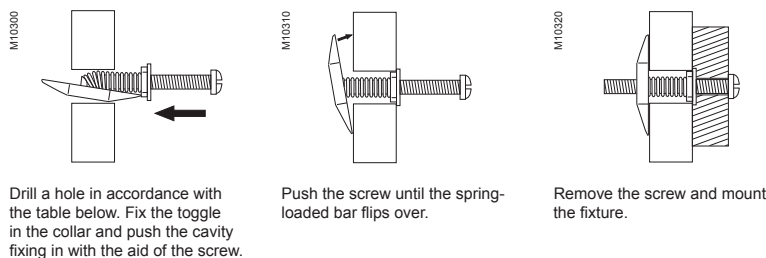





Technical data

Type	Screw size	Drill Ø mm	Board thickness mm	Max. fixture thickness for board thickness		Practical loading capacity, shear/pull-out load, N*	
				13 mm	2x13 mm	13 mm	2x13 mm
TPP-10xM4S	M4x55	10	10-30	37 mm	24 mm	400/160	600/220
TPP-10xM4K	M4x50	10	10-26	—	—	— /160	— /220
TPP-13xM5S	M5x65	13	10-35	47 mm	34 mm	500/170	800/340

* Safety factor 2.5 for shear and 3 for pull-out load.

Range

Type	Screw size	Qty per package	EAN code	Ref. No.		
Cavity fixing with screw						
Metal cavity fixing with screw. Large captive toggle. Suitable for mounting in walls and ceilings made of board material. Can be used in 10-26 mm board thickness. Material: Toggle and collar of zinc, screw and spring of steel.						
P40037		TPP-10xM4S	Screw M4 x 55	25	7315881200009	1200 005
		TPP-13xM5S	Screw M5 x 60	25	7315881200405	1200 401
Cavity fixing with hook						
Metal cavity fixing with hook. Large captive toggle. Suitable for mounting in walls and ceilings made of board material. Can be used in 10-26 mm board thickness. Material: Toggle and collar of zinc, hook and spring of steel.						
P40037		TPP-10xM4K	Hook M4 x 50	25	7315881200207	1200 203
Cavity fixing with screw, bulk						
Like the above with screw but in bulk package.						
P40037		TPP-10xM4S	Screw M4 x 55	1500	7315881200023	1200 023
		TPP-13xM5S	Screw M5 x 60	1000	7315881200412	1200 412
Cavity fixing with hook, bulk						
Like the above with hook but in bulk package.						
P40037		TPP-10xM4K	Hook M4 x 50	1000	7315881200221	1200 221
Cavity fixing, bulk						
Like the above but without screw or hook and in bulk package.						
		TPP-13xM5	—	1000	7315881200443	1200 443

Cavity fixing

Thorsman DUO-MAX™ TSP

P124786



Description

DUO-MAX TSP is a plastic cavity fixing for high load values. TSP is provided with a pre-assembled screw or hook.

Application

For installations in board materials ranging from a thickness of 3 to 35 mm. TSP of type M has a nickel-plated brass screw for installations in for instance wet rooms.

Benefits

- Captive fixing
- No special tool needed for the installation
- Pre-assembled screw or hook
- Ready-to-mount – very fast installation
- High load values
- Corrosion resistant
- Easy to remove – cut off the spring

Material data

Material	Collar, spring, expanding part: PA (polyamide).		
	Hook:	Electroplated steel.	
	Screw:	Electroplated steel.	
	Screw type M:	Nickel-plated brass.	

Operative data

Temperature range	-40°C to +80°C.
-------------------	-----------------

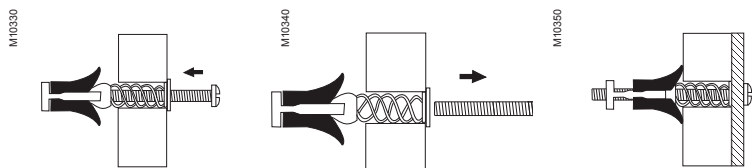
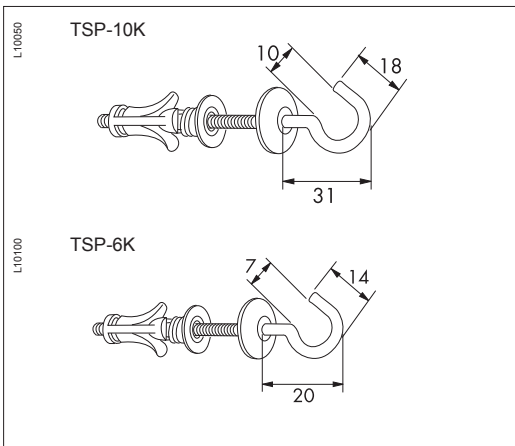

Drill a hole in accordance with the table below. Push in DUO-MAX with the aid of the screw.

Remove the screw.





Mount the fixture.

Technical data

Type	Screw size	Drill Ø mm	Board thickness mm	Max. fixture thickness in board thickness		Practical loading capacity, N*			
				13 mm	2x13 mm	13 mm sheet		2x13 mm sheet	
						Shear	Pull-out	Shear	Pull-out
TSP-6/50	M3x50	6	3-26	20 mm	7 mm	180	70	240	90
TSP-6K	M3x40	6	3-20	—	—	180	70	—	—
TSP-10/50	M5x50	10	3-20	12 mm	—	250	75	—	—
TSP-10/65	M5x65	10	3-35	25 mm	12 mm	250	75	400	150
TSP-10/75	M5x75	10	3-40	37 mm	24 mm	250	75	400	150
TSP-10/75M	M5x75	10	3-38	34 mm	21 mm	250	75	400	150
TSP-10K	M5x60	10	3-28	—	—	250	75	400	150

* Safety factor 4.5 for shear and 6 for pull-out load.

Range

Type	Colour	Dimensions A/B (mm)		Qty per package	EAN code	Ref. No.
Cavity fixing with screw						
Cavity fixing in two different sizes, with screw. Installed without special tools. To be used for installations in one or several layers of plasterboard and in other board materials. Type M in stainless material (nickel-plated brass) for instance for wet rooms. Material: PA (polyamide). Screw of electroplated steel. Type M with screw of nickel-plated brass.						
 P80835 P80818	TSP-6/50	Red/white	52/11	25	7315881240005	1240 001
	TSP-10/50	Blue/white	54/20	25	7315881244003	1244 003
	TSP-10/65	Blue/white	68/20	25	7315881248001	1248 004
	TSP-10/75	Blue/white	77/20	25	7315881249008	1249 002
	TSP-10/75M				7315881250004	1250 000
Cavity fixing with hook						
Cavity fixing in two different sizes, with hook. Installed without special tools. To be used for installations in one or several layers of plasterboard and in other board materials. Material: PA (polyamide). Hook of electroplated steel.						
 P80836	TSP-6K	Red/white	60/11	25	7315881241002	1241 009
	TSP-10K	Blue/white	93/20	25	7315881253005	1253 004
Cavity fixing with screw, bulk						
Like the above but in bulk package.						
 P80835 P80818	TSP-6/50	Red/white	52/11	6000	7315881240708	1240 704
	TSP-10/50	Blue/white	54/20	2500	7315881244706	1244 706
	TSP-10/75	Blue/white	77/20	1500	7315881249503	1249 507
Cavity fixing with hook, bulk						
Like the above but in bulk package.						
 P80836	TSP-10K	Blue/white	93/20	1000	7315881253500	1253 509



Description

MONO-MAX TMM is a plastic cavity fixing for lightweight installations in plasterboard. Supplied without screw.

Application

For installations in board materials ranging from 3 to 26 mm thickness.

Benefits

- Captive without screw
- No special tool needed for the installation
- Requires only 15 mm of cavity space behind the board
- Small drill hole – 8 mm
- Easy to remove – cut off the spring

Material data

Material PA (polyamide)

Operative data

Temperature range –40°C to +80°C.

Mounting instruction

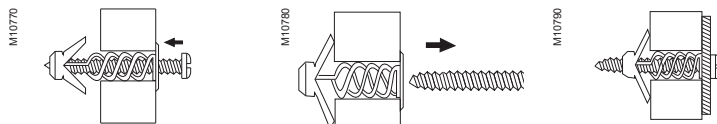

Drill a hole, Ø 8 mm. Push the cavity fixing in with the aid of the screw.

When the wings are gripping, remove the screw.

Mount the fixture.

Technical data

Type	Rec. wood screw	Drill Ø mm	Board thickness, mm	Max. fixture thickness	Practical loading capacity, shear/pull-out load, N*
TMM-8x26	No. 8	8	3-26	Determined by screw length	200/60

* Safety factor 4.5 for shear and 6 for pull-out load.

Range

P125429



Type	Colour	Dim. mm	Qty per package	EAN code	Ref. No.
Cavity fixing without screw					
Cavity fixing without screw for lightweight installations in board materials. Material: PA (polyamide).					
TMM-8x26	White	26/13/16	100	7315881206025	1206 028

Cavity fixing

Thorsman TMX

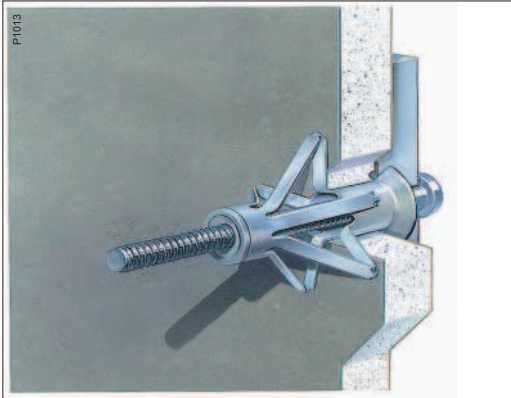

Description

TMX steel cavity fixing is intended for heavy loads. It is expanded with the aid of the installation tool or simply by tightening the screw with a screw-driver.

Application

For installations in various types of board up to a thickness of 44 mm, like plaster, plywood and particle boards, but also for board materials like plastic, sheet metal and laminate.

Benefits

- Captive fixing – stays fixed even when the screw is not tightened
- Anti-rotation design
- Pre-assembled screw
- High load values
- Fire-resistant

Material data

Material cavity fixing	Expanding part:	Electroplated sheet metal
	Screw:	Electroplated steel
Material mounting tool	Steel and plastic.	

Operative data

Temperature range	-40°C to +80°C.
-------------------	-----------------

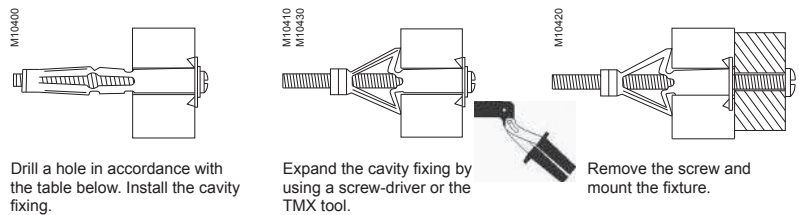

Technical data

Type	Screw	Screw length mm	Drill Ø mm	Board thickness Min-max mm	Max fixture thickness mm	Practical loading capacity, N*	
						Shear load	Pull-out load
TMX-4E	M4	40	8	5-15	18	200	140
TMX-4D	M4	50	8	16-26	18	400	160
TMX-5E	M5	57	10	6-13	24	400	160
TMX-5D	M5	70	10	12-32	20	600	200
TMX-6E	M6	57	12	3-16	25	450	180
TMX-6D	M6	70	12	12-32	20	700	280

* Safety factor 2.5 for shear and 3 for pull-out load.

Range TMX

Type	Screw	Dimensions Ø/L (mm)	Qty per package	EAN code	Ref. No.
Cavity fixing with screw					
Cavity fixing including fully threaded screw with combi-head and Phillips cross-slot. Material: Electroplated steel.					
TMX-4E	M4	14/47	100	7315881260027	1260 025
TMX-4D	M4	14/62	50	7315881260065	1260 066
TMX-5E	M5	16/62	50	7315881260102	1260 108
TMX-5D	M5	16/74	50	7315881260126	1260 124
TMX-6E	M6	18/62	50	7315881260140	1260 140
TMX-6D	M6	18/74	50	7315881260164	1260 165
Installation tool					
Installation tool for cavity fixing TMX. Material: Steel, plastic.					
TMX-T	—	100/250/32	1	7315881265046	1265 040

P125723
P125726
P125729
P80838



Cavity fixing

Thorsman TPD

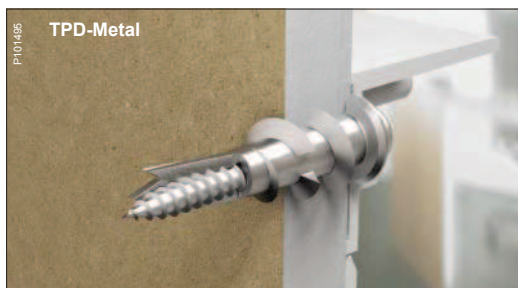

Description

TPD self-drilling cavity fixing is intended for lightweight installations in plasterboard.

Application

For installations in plasterboard from a thickness of 9 mm, independent of the insulation behind. Not suitable for ceiling installations.

Benefits

- Self-drilling – preferably installed with a cordless screwdriver Pozidriv (PZ) 2 without pre-drilling
- Wood screw 4.5x35 with 8 mm head and cross-slot Pozidriv 2 (TPD-Metal)
- For plasterboards from a thickness of 9 mm, including multiple sheet thicknesses (TPD-Metal)
- Fire resistant (TPD-Metal)
- Screw with high pitch, easy and fast (TPD-Metal)

Material data

Material	TPD-Metal Zinc
	TPD-Nylon PA (polyamide), glass fibre reinforced
Screw	Electroplated steel (TPD-Metal)

Operative data

Temperature range	-40°C to +80°C.
-------------------	-----------------

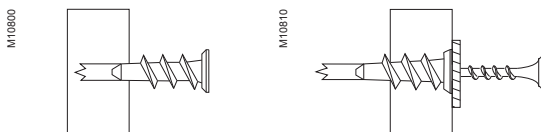

Screw the TPD into the plasterboard.

Mount the fixture by screwing the screw into the TPD.

Technical data

Type	Screw size mm	Board thickness mm	Max. fixture thickness mm	Practical loading capacity, shear/pull-out load in 13 mm board, N*
TPD-Metal	4.5x35	min. 9	26	270/80
TPD-Nylon	4.5x35	min. 9	12	190/50

* Safety factor 2.5 for shear and 3 for pull-out load (TPD-Metal).
Safety factor 4.5 for shear and 6 for pull-out load (TPD-Nylon).

Range



Type	Screw size	Colour	Dim. Ø/L mm	Qty per package	EAN code	Ref. No.
Cavity fixing, zinc						
Cavity fixing for lightweight installations in plasterboard, including wood screw with cross-slot Pozidriv 2. Material: Zinc. Electroplated steel screw.						
TPD-Metal	4.5x35	—	13/37	100 25	7315880114291 7315881220120	1220 104 1220 120
Cavity fixing, PA						
Cavity fixing for lightweight installations in plasterboard, including screw with cross-slot. Material: PA (polyamide), glass fibre reinforced. Electroplated steel screw.						
TPD-Nylon	—	White	13/37	100	7315881220014	1220 010



Description THW

THW metal cavity fixing including screw is excellent for installations in plasterboard materials. The shape of THW prevents it from rotating. No pre-drilling needed, just hammer in.

Application

For lightweight installations in board materials ranging from 6 to 13 mm thickness, excellent for porous and thin materials.

Benefits

- No pre-drilling needed
- Screw with sharp point, Phillips PH2
- Fire-resistant
- Easy to remove
- Leaves a very small hole in plasterboard when removed

Material data

Material	Cavity fixing	Yellow-chromated steel
	Screw	Electroplated steel

Operative data

Temperature range	-40°C to +80°C.
-------------------	-----------------

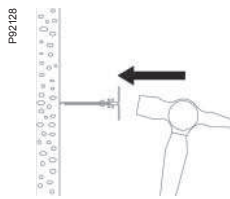

Hammer the cavity fixing in place. No pre-drilling needed.

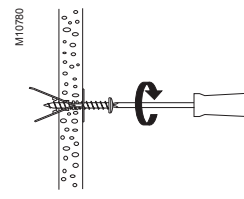

Mount the fixture with the included Phillips PH2 screw (cross-recessed).

Technical data

Type	Screw	Board thickness mm	Max. fixture thickness mm	Practical loading capacity, shear/pull-out, N*
THW 4.2x38	4.2x38	6-13	16	100/100

* Safety factor 2.5 for shear and 3 for pull-out load.

Range

P91678



Type	Screw size	Colour	Dim. mm	Qty per package	EAN code	Ref. No.
Cavity fixing including screw						
Cavity fixing including screw. The shape of THW prevents it from rotating. No pre-drilling needed, just hammer in. Material: Steel, yellow-chromated (THW), electroplated (screw).						
THW 4.2x38	4.2x38	—	10/30/12	50	7315881260171	1260 170